

RigPAC®

Vendor-Managed Inventory (VMI)



DistributionNOW offers custom vendor-managed inventory (VMI) solutions for land-based drilling activities, utilizing our supply chain technologies to reduce the burden of inventory management and avoid downtime.

RigPAC is a secure consignment container that provides savings through supply chain cost reduction, risk mitigation, and elimination of excess purchasing. It is a secure and reliable non-manned supply source that is serviced by DistributionNOW.

BENEFITS

Overall, the RigPAC consignment container has 6 significant benefits for our customers:

1. Reduction of "just-in-case" inventory within the customer's operations
2. Focus on core operations through consignment inventory service
3. Minimize rig downtime due to a reduction in delivery lead times
4. Customizable inventory with items available 24/7
5. Increased visibility of spend through KPI analysis
6. Safety assurance provided by the on-board equipment

SAFETY

RigPAC is designed to be safe for workers. There are 2 exits – a primary door in the side wall and a container door on the end for loading/unloading and emergency situations. Flammable products, such as paints, fuel, or aerosols, should be stored in the flammables cabinet provided. The integrated air conditioning (A/C) unit can provide climate control as needed. In case of fire, use the class A/B/C fire extinguisher provided next to the primary door.

EMERGENCY EQUIPMENT

Containers may be outfitted with the following additional emergency equipment:

- First aid kit
- Eyewash station
- Automated external defibrillator (AED)



RigPAC[®]

Vendor-Managed Inventory (VMI)



DESIGN

While basic specifications may vary by model, the following represents a basic design:

- Standard 40 ft. x 8 ft. x 8.5 ft. (LxWxH) shipping container
- External 220V single phase power connection
- 193 storage bins for materials
- Workbench
- Fire extinguisher
- Flammable products storage
- Air conditioning (A/C)
- Primary entrance/exit in side wall
- Operating manual included

The container's design may be modified from the above design to meet specific customer needs. These modifications may include CAT5 cable for internet connectivity, custom shelving or storage, a desk, or other customizations.



Interior wall with workbench, shelving, and side door

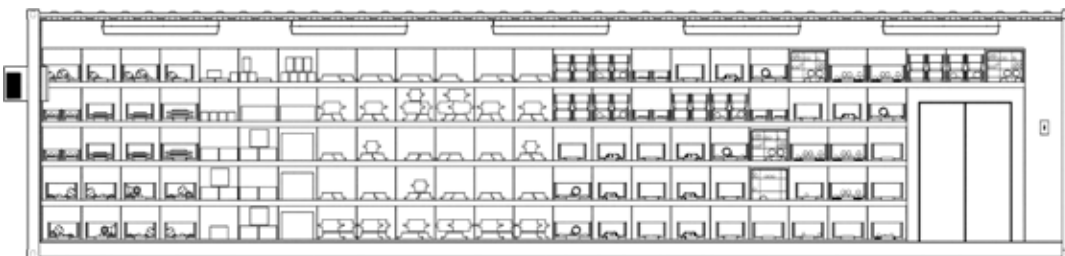

Interior wall with shelving and flammables cabinet

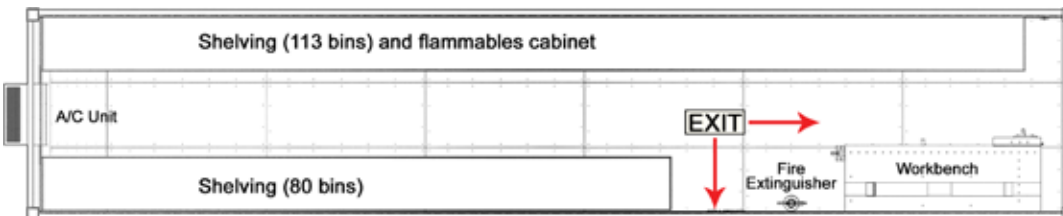

Overhead view of floorplan

DistributionNOW has produced this for general information only, and it is not intended for design purposes. Although every effort has been made to maintain the accuracy and reliability of its contents, DistributionNOW in no way assumes responsibility for liability for any loss, damage or injury resulting from the use of information and data herein. All applications for the material described are at the user's risk and are the user's responsibility.